

213 PEARL STREET

RETAIL FOR
LEASE
NEW YORK,
NY 10038

FINANCIAL DISTRICT

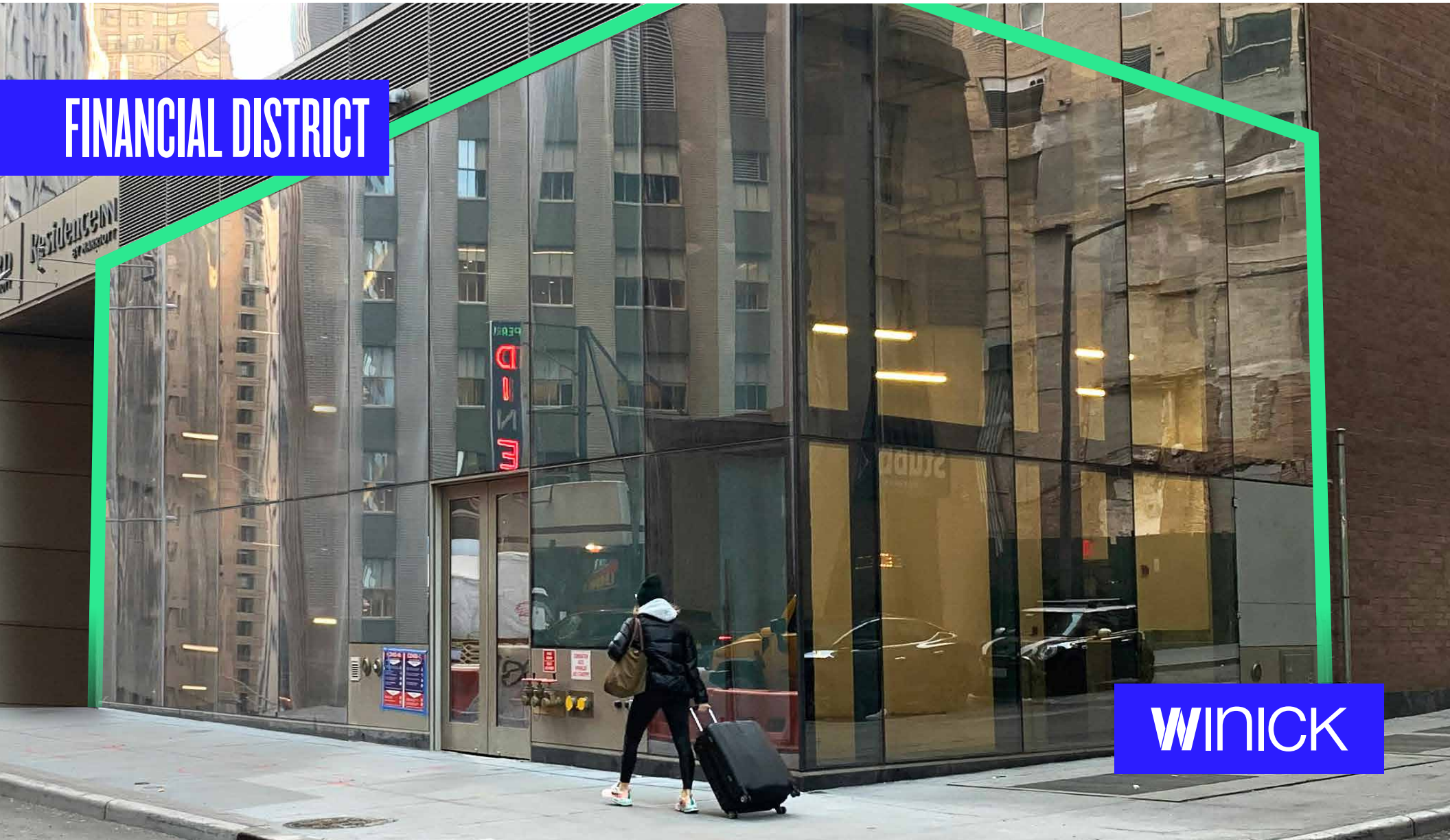

WINICK

213 PEARL STREET

NEW YORK, NY 10038

| Southwest Corner of Pearl & Platt Streets |

SIZE (approx.)

Ground Floor: 1,300 SF - 22' Ceilings

FRONTAGE (approx.)

Over 75' of wraparound frontage

POSSESSION

Immediate

ASKING PRICE

Upon Request

COMMENTS

- Located at the base of a new luxury hotel (320 rooms)
- Beautiful glass façade
- All uses considered
- Storage can be made available

NEIGHBORS

Juice Generation • Just Salad • Fields Good
Chicken • Dos Toros • Soul Cycle • Five Guys

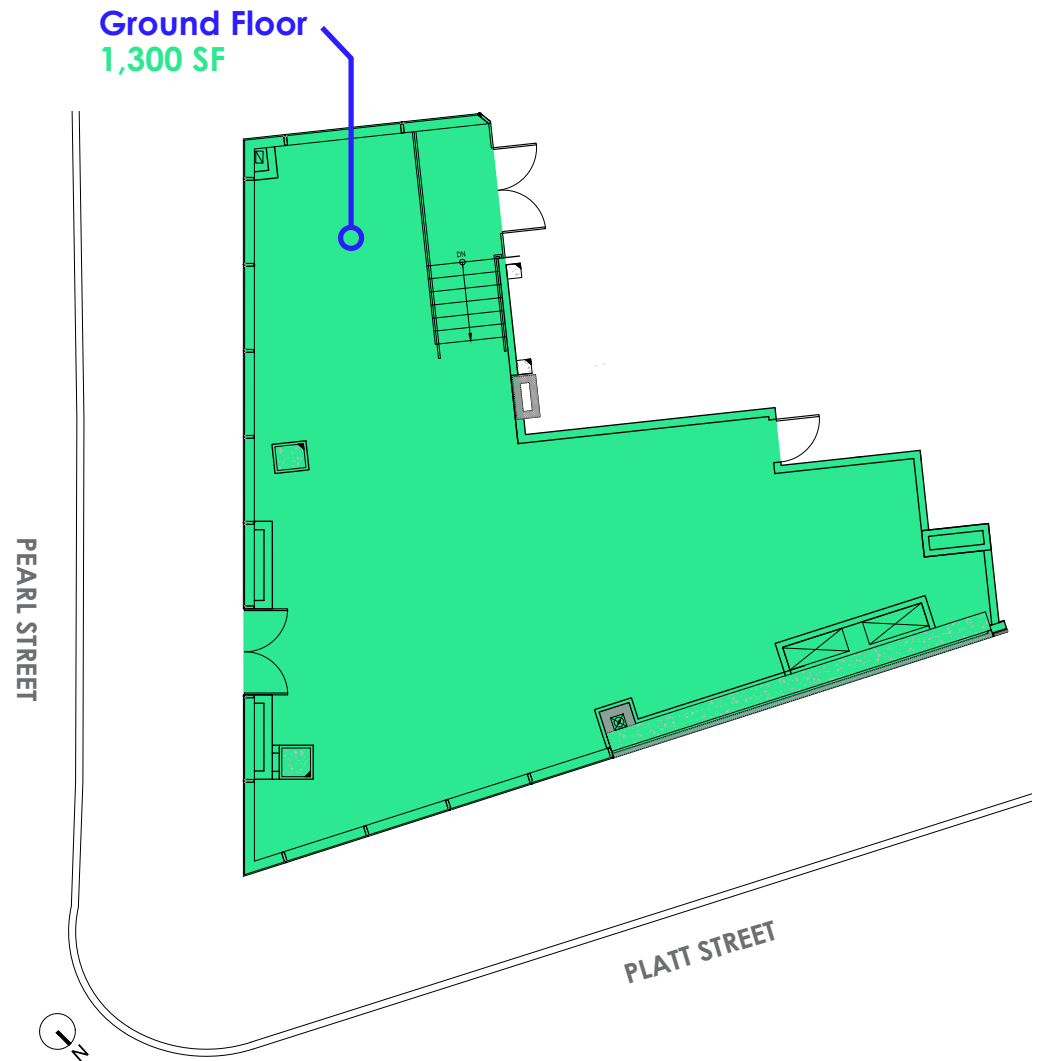

Winick Realty Group LLC, Licensed Real Estate Brokers
655 Third Avenue, 17th Floor | New York, NY 10017
T 212.792.2600 | F 212.792.2660 | winick.com

For more information, please
contact exclusive agent:

Charles Rapuano

212.792.2658
charles@winick.com

Jacob Rosen

212.792.2659
jrosen@winick.com

ALTHOUGH ALL INFORMATION REGARDING PROPERTY FOR SALE, RENTAL OR FINANCING IS FROM SOURCES DEEMED RELIABLE SUCH INFORMATION HAS NOT BEEN VERIFIED, AND NO EXPRESS REPRESENTATION IS MADE NOR IS ANY TO BE IMPLIED AS TO THE ACCURACY THEREOF, AND IT IS SUBMITTED SUBJECT TO ERRORS, OMISSIONS, CHANGE OF PRICE, RENTAL OR OTHER CONDITIONS, PRIOR SALE, LEASE OR FINANCING, OR WITHDRAWAL WITHOUT NOTICE



WINICK

Winick Realty Group LLC, Licensed Real Estate Brokers
 655 Third Avenue, 17th Floor | New York, NY 10017
 T 212.792.2600 | F 212.792.2660 | winick.com

For more information, please
 contact exclusive agent:

Charles Rapuano

212.792.2658
 charles@winick.com

Jacob Rosen

212.792.2659
 jrosen@winick.com

ALTHOUGH ALL INFORMATION REGARDING PROPERTY FOR SALE, RENTAL OR FINANCING IS FROM SOURCES DEEMED RELIABLE SUCH INFORMATION HAS NOT BEEN VERIFIED, AND NO EXPRESS REPRESENTATION IS MADE NOR IS ANY TO BE IMPLIED AS TO THE ACCURACY THEREOF, AND IT IS SUBMITTED SUBJECT TO ERRORS, OMISSIONS, CHANGE OF PRICE, RENTAL OR OTHER CONDITIONS, PRIOR SALE, LEASE OR FINANCING, OR WITHDRAWAL WITHOUT NOTICE