

The Retail at Gotham Plaza

149-169 East 125th Street



The Retail at Gotham Plaza

149-169 East 125th Street



GROUND FLOOR

6,110 SF*

*Divisions considered

FRONTAGE

54 FT

POSSESSION

Immediate

NEARBY SUBWAY LINES



FEATURES

- At the base of a multi-use building with 233 units
- 15.5 ft of ceiling heights

CO-TENANTS



Foot Locker



(COMING SOON)



TACO BELL

Lexington Avenue

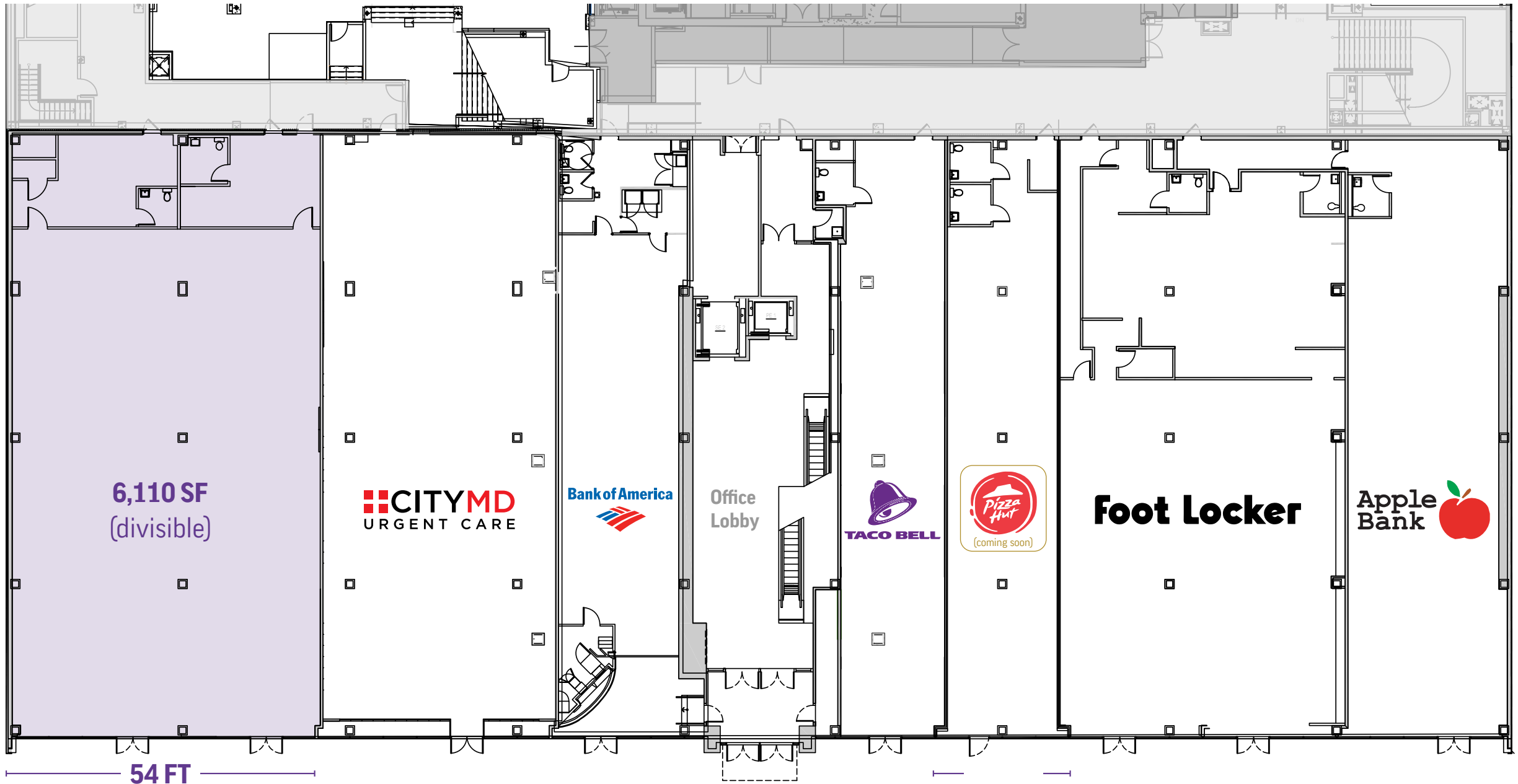

6,110 SF
(divisible)

54 FT

 **CITYMD**
URGENT CARE

 Bank of America

Office
Lobby

 TACO BELL

 Pizza Hut
(coming soon)

Foot Locker

Apple 
Bank

Third Avenue

East 125th Street

Division Layout Option 1

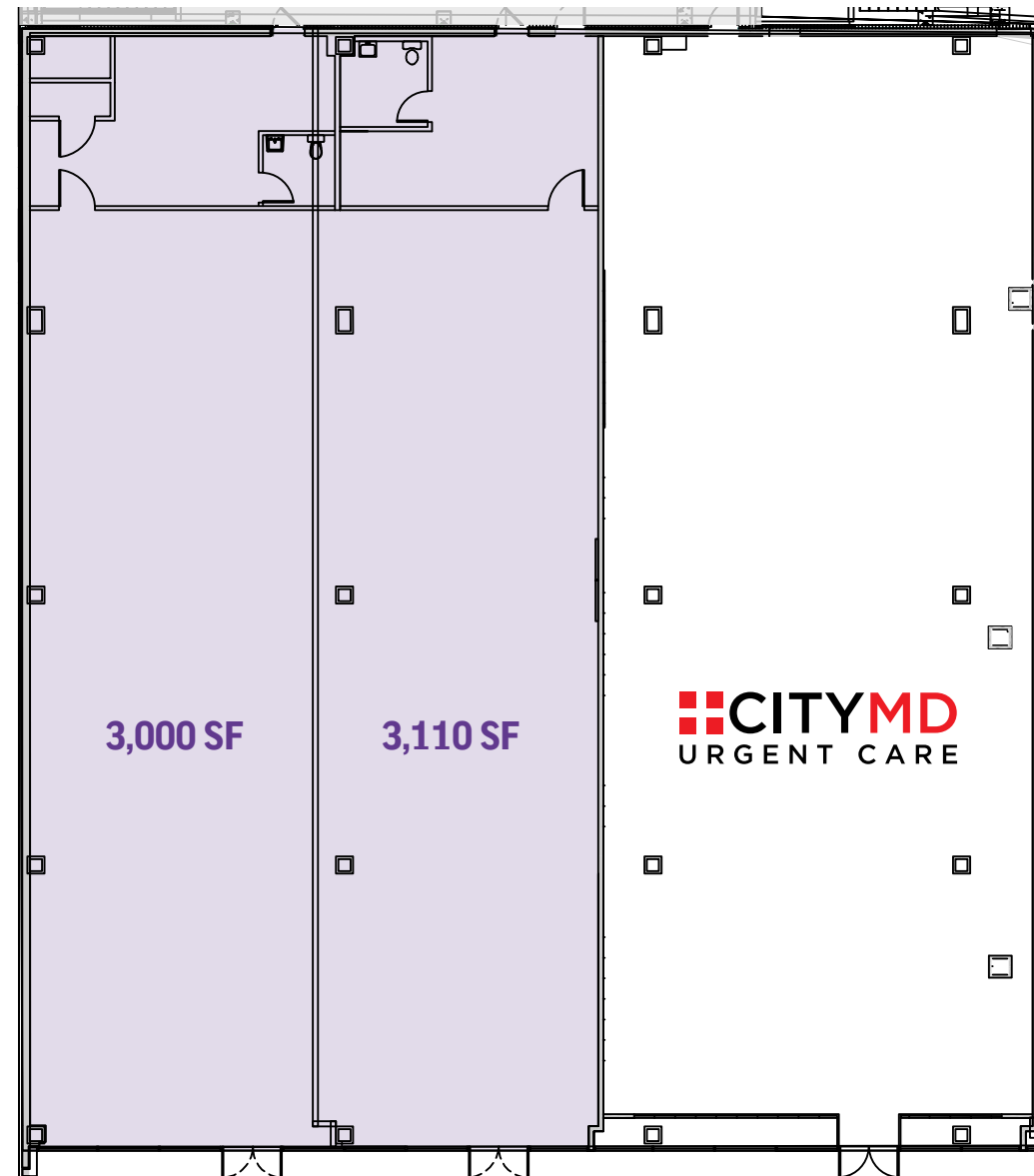

27 FT 27 FT

East 125th Street

Division Layout Option 2

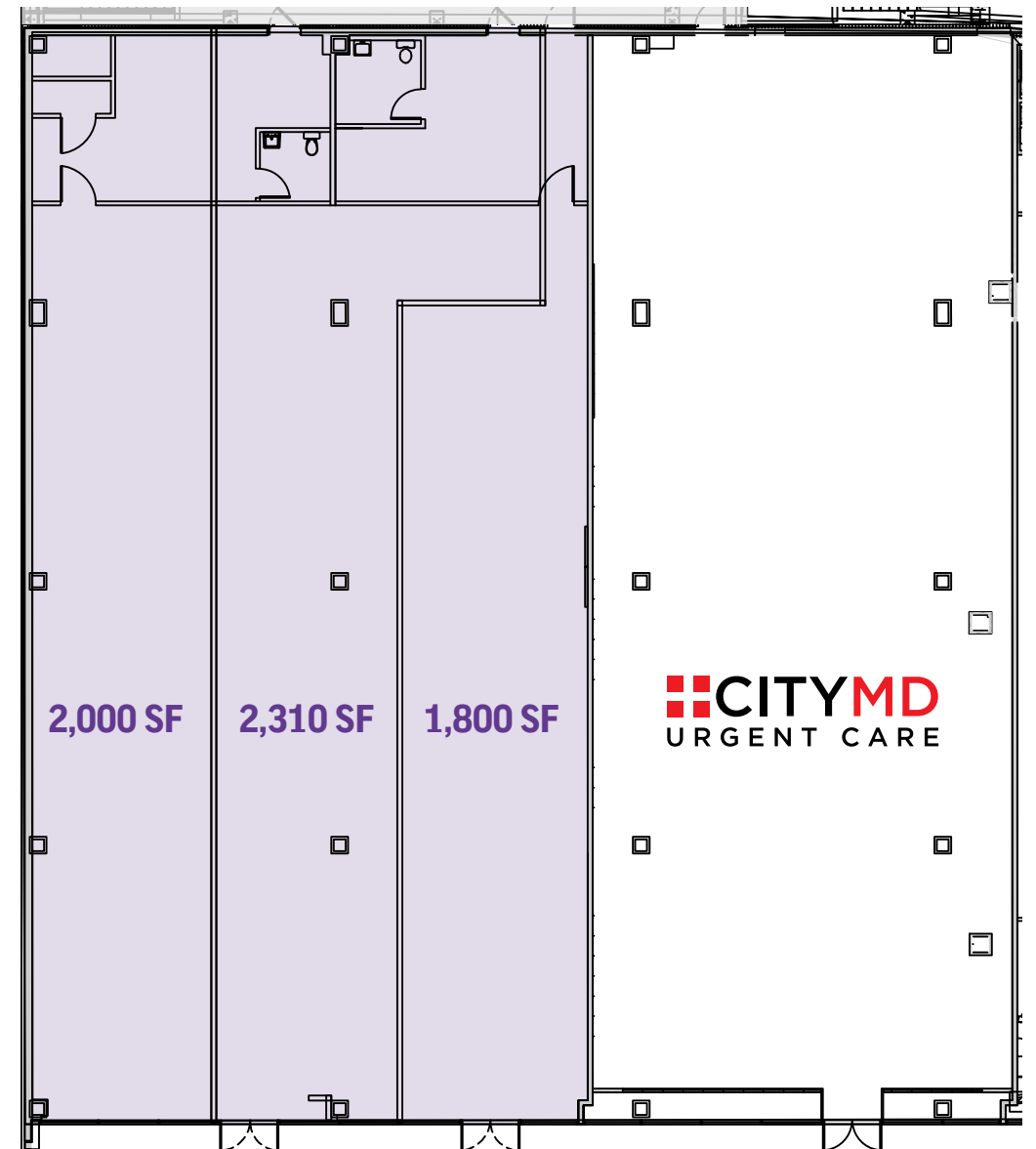

18 FT 18 FT 18 FT

East 125th Street

Join these co-tenants at Gotham Plaza



Foot Locker

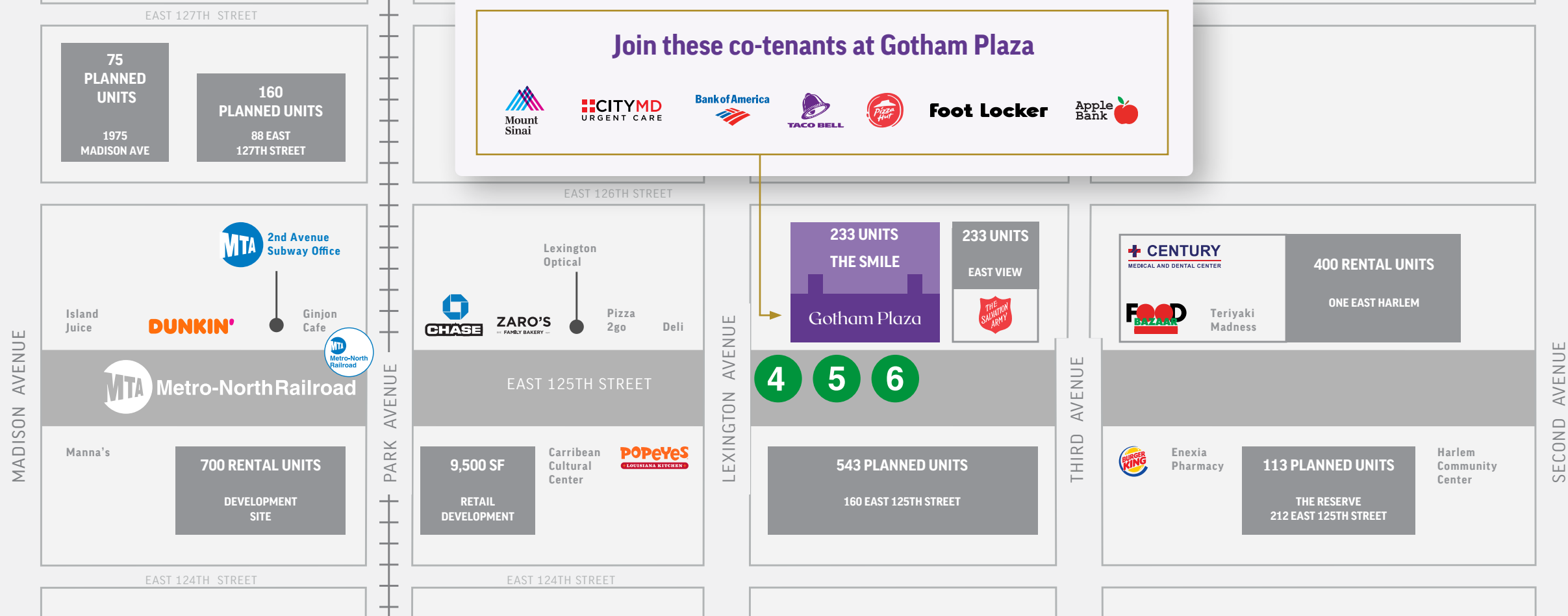

The Retail at Gotham Plaza

East Harlem - New York



Winick Realty Group LLC, Licensed Real Estate Brokers
655 Third Avenue, 24th Floor | New York, NY 10017
T 212.792.2600 | F 212.792.2660 | winick.com

ALTHOUGH ALL INFORMATION REGARDING PROPERTY FOR SALE, RENTAL OR FINANCING IS FROM SOURCES DEEMED RELIABLE SUCH INFORMATION HAS NOT BEEN VERIFIED, AND NO EXPRESS REPRESENTATION IS MADE NOR IS ANY TO BE IMPLIED AS TO THE ACCURACY THEREOF, AND IT IS SUBMITTED SUBJECT TO ERRORS, OMISSIONS, CHANGE OF PRICE, RENTAL OR OTHER CONDITIONS, PRIOR SALE, LEASE OR FINANCING, OR WITHDRAWAL WITHOUT NOTICE

For more information, please contact our exclusive agents:

Lee Block
212-792-2649
lee@winick.com

Amanda Lagowitz
212-792-2619
alagowitz@winick.com